

REV.	ECN NO.	DATE	SIGN	DESCRIPTION
C	LE3-910024	2009/01/06	Vicky	Modify the Wire Harness
D	LEN1350144	2013/05/08	Lu Di	Change Logo
E	LE31730071	2017/03/02	Ruru	Change Outer Mold Design

Conn. 2

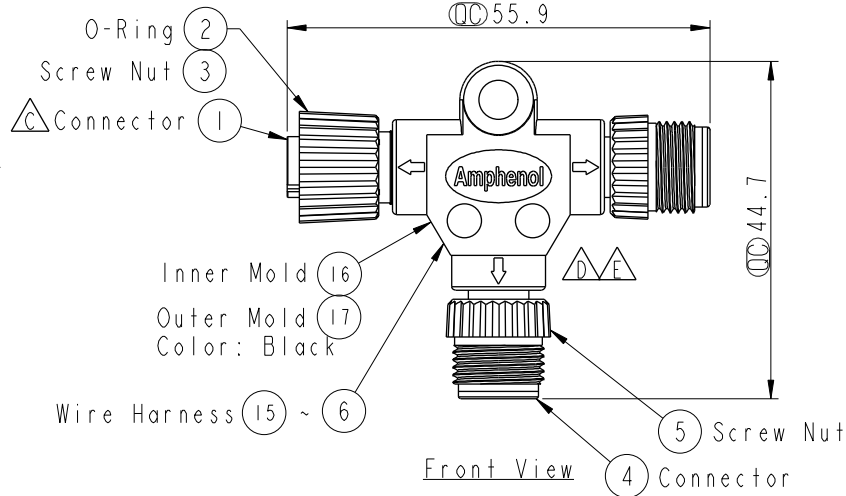

Conn. 3

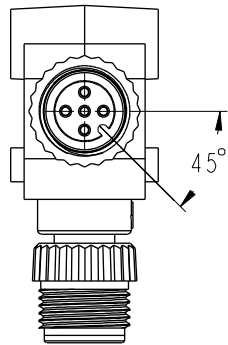
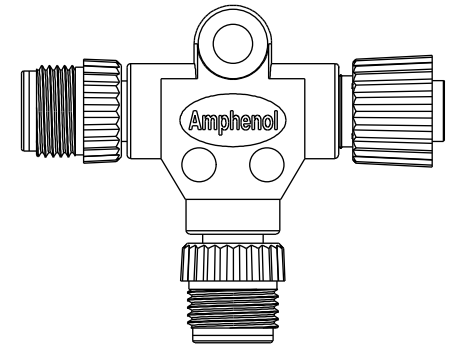
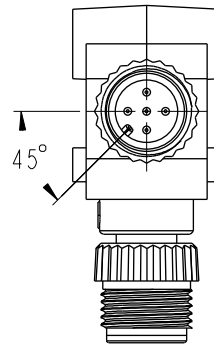

Back View

Front View

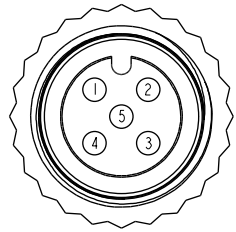

Conn. 2  
Pin Assignments  
Front View

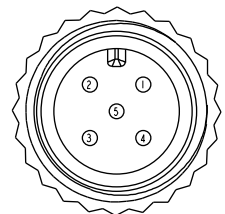
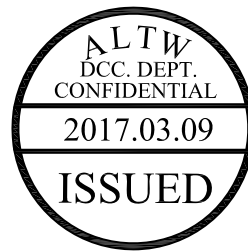

Conn. 1&3  
Pin Assignments  
Front View

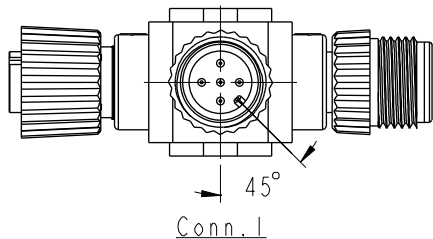

Conn. 1

Blue (24AWG) 藍	5	5	5
White (24AWG) 白	4	4	4
Black (22AWG) 黑	3	3	3
Red (22AWG) 紅	2	2	2
Green (24AWG) 綠	1	1	1
Wire Color	Conn. 1	Conn. 2	Conn. 3

Pin Out



- Note:
- \*  $\varnothing$  Important Dimension
  - \* Waterproof Rate: IP68  
In 1 meter water within 24 hours
  - \* Connector: PU, Black
  - \* O- Ring: Viton, Green
  - \* Screw Nut: Nylon+GF, Black
  - \* Pin: Copper Alloy, Gold Plated
  - \* Wire Harness: UL1061 24AWG, Green, White, Blue
  - \* Wire Harness: UL1061 22AWG, Red, Black

UNIT:mm

TOLERANCE  $\pm 0.5mm$

TITLE			
M12 Conn T Adaptor			
MFM Conn MFM Pin, 5Pin			
SCALE	SIZE	SHEET OF	
1:1	A4	1 OF 1	
REV.	WC-REV.	$\varnothing$ : Inspection item	
E	A.1		

**Amphenol LTW**  
安費諾亮泰企業股份有限公司

ITEM NO	DRAWN BY	DATE
PS-050505-MFM-TS001	Ruru	2017-03-02
DWG NO	CHECKED BY	DATE
PS-050505-MFM-TS001	Rita	2017-03-02
CUSTOMER	APPROVED BY	DATE
ALTW	Max	2017-03-02

THIS DOCUMENT IS SUBJECT TO CHANGE WITHOUT NOTICE. IT IS CONFIDENTIAL AND A PROPERTY OF Amphenol LTW. DISCLOSURE TO THIRD PARTY HAS TO BE AUTHORIZED BY Amphenol LTW.