

REV.	ECN NO.	DATE	SIGN	DESCRIPTION
C	LE3-910020	2009/01/06	Vicky	Modify the Wire Harness
D	LEN1350141	2013/05/08	Lu Di	Change Logo
E	LE31730067	2017/03/02	Ruru	Change Outer Mold Design

Conn. 2

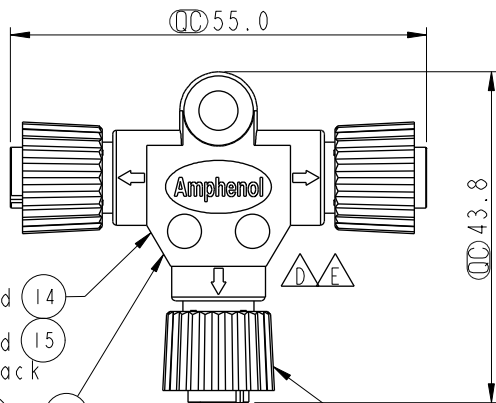

Conn. 3

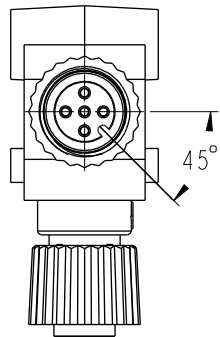
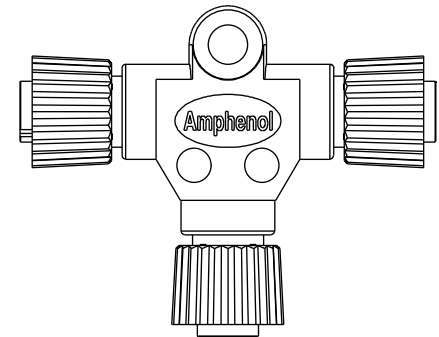
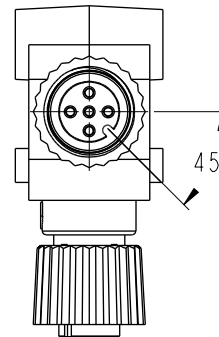

Inner Mold (14)
 Outer Mold (15)
 Color: Black
 Wire Harness (13) ~ (4)
 Connector (1)
 O-Ring (2)
 Screw Nut (3)

Back View

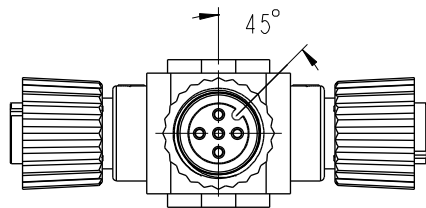
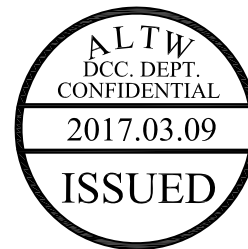

Conn. 1

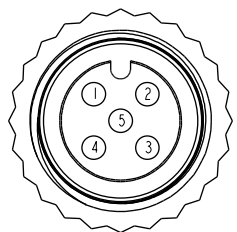
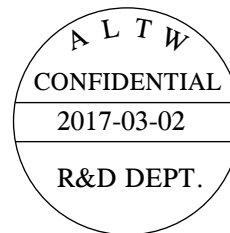

Pin Assignments Front View

Blue (24AWG) 藍	5	5	5
White (24AWG) 白	4	4	4
Black (22AWG) 黑	3	3	3
Red (22AWG) 紅	2	2	2
Green (24AWG) 綠	1	1	1
Wire Color	Conn. 1	Conn. 2	Conn. 3

Pin Out

Note:

- * \varnothing Important Dimension
- * Waterproof Rate: IP68
In 1 meter water within 24 hours
- * Connector: PU, Black
- * O- Ring: Viton, Green
- * Screw Nut: Nylon+GF, Black
- * Pin: Copper Alloy, Gold Plated
- * Wire Harness: UL1061 24AWG, Green, White, Blue
- * Wire Harness: UL1061 22AWG, Red, Black

UNIT:mm

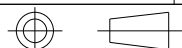

TOLERANCE

$\pm 0.5mm$

TITLE			
M12 Conn T Adaptor FFF Conn FFF Pin, 5Pin			
SCALE	SIZE	SHEET	OF
1:1	A4	1	1
REV.	WC-REV.	\varnothing : Inspection item	
E	A.1		

Amphenol LTW
 安費諾亮泰企業股份有限公司

ITEM NO.	DRAWN BY	DATE
PS-050505-FFF-TS001	Ruru	2017-03-02
DWG NO.	CHECKED BY	DATE
PS-050505-FFF-TS001	Rita	2017-03-02
CUSTOMER	APPROVED BY	DATE
ALTW	Max	2017-03-02

THIS DOCUMENT IS SUBJECT TO CHANGE WITHOUT NOTICE. IT IS CONFIDENTIAL AND A PROPERTY OF Amphenol LTW. DISCLOSURE TO THIRD PARTY HAS TO BE AUTHORIZED BY Amphenol LTW.