

THIS DOCUMENT IS SUBJECT TO CHANGE WITHOUT NOTICE. IT IS CONFIDENTIAL AND A PROPERTY OF AMPHENOL LTW. DISCLOSURE TO THIRD PARTY HAS TO BE AUTHORIZED BY AMPHENOL LTW.

REV.	ECN NO.	DATE	SIGN	DESCRIPTION
A		2011/12/03	Tao-Cheng	Change Rev.05 To Rev.A
B	LEN12A0083~86	2012/10/18	Tao-Cheng	Update SR
C	LEN1770101~04	2017/06/27	Ruru	Change Logo

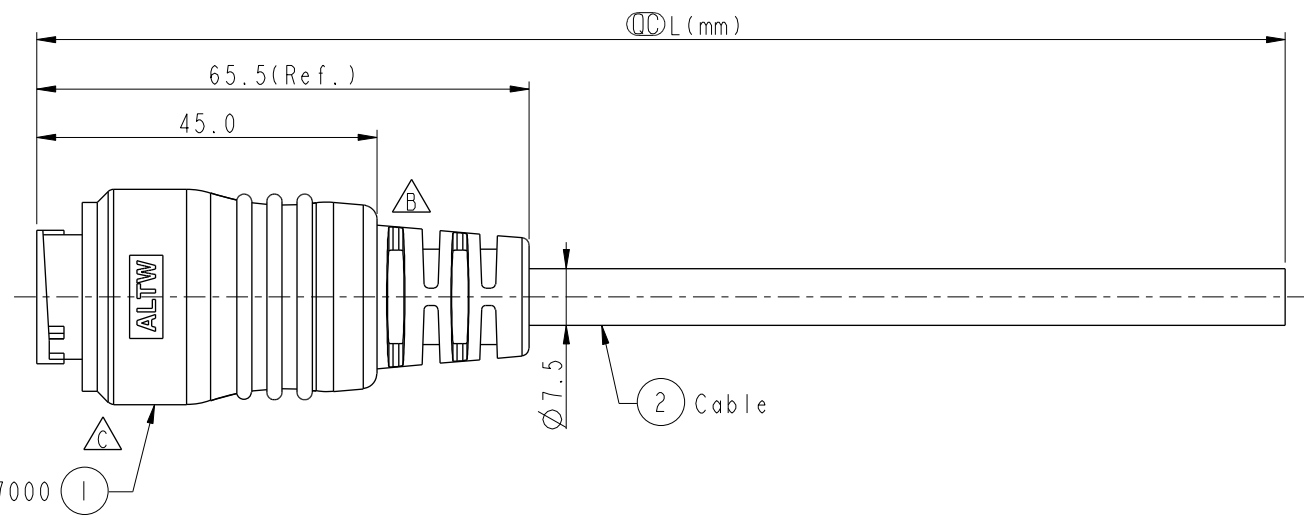

PWCU-04AMMM-LL7000

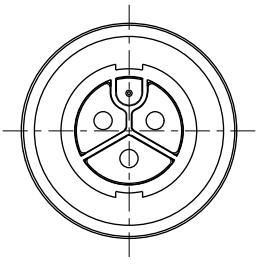
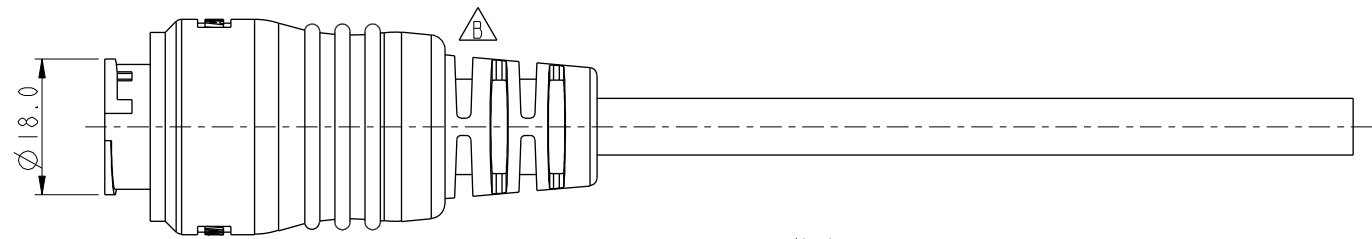

PWCU-04AMMM-LL7AXX

XX:01~99Meters
 01:01Meter
 02:02Meter
 ...
 99:99Meters

Cable Length(L):01~99Meters

- Note:
- * \varnothing Important Dimension To Check
 - * Waterproof Rate: IP67 (Mated)
 - * Connector: Nylon+GF, Black
 - * Male Pin: Copper Alloy, Gold Flash
 - * Cable: UL2464, 16AWG*3C+Drain+Al/Mylar PVC Jacket, UV Resistant, OD=7.5mm, Black
 - * Cable Length Tolerance: 01M±40mm
 02M~05M:±60mm
 06M~10M:±100mm
 11M~30M:±200mm
 31M~99M:±500mm

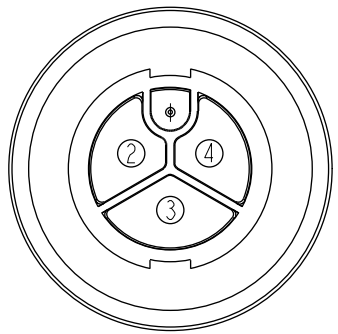

Pin Assignments Front View

4	Black	黑
3	Blue	藍
2	Brown	棕
1	Drain	地線
Conn.	Wire Color	Pin Out

UNIT:mm

TOLERANCE	
.X	±0.25
.XX	±0.1
.XXX	±0.05
ANGLES	±1°

TITLE			
Power, Cable Lock 4Pin M Conn. M Pin (2A+20A)			
SCALE	1:1	SIZE	A4
SHEET	1	OF	1
REV.	C	WC-REV.	A.1
<div style="display: flex; align-items: center;"> QC: Inspection item </div>			

Amphenol LTW

安費諾亮泰企業股份有限公司

ITEM NO	DRAWN BY	DATE
	Ruru	2017-06-27
DWG NO	CHECKED BY	DATE
PWCU-04AMMM-LL7AXX	Rita	2017-06-27
CUSTOMER	APPROVED BY	DATE
ALTW	Max	2017-06-27