

THIS DOCUMENT IS SUBJECT TO CHANGE WITHOUT NOTICE. IT IS CONFIDENTIAL AND A PROPERTY OF Amphenol LTW. DISCLOSURE TO THIRD PARTY HAS TO BE AUTHORIZED BY Amphenol LTW.

REV.	ECN NO.	DATE	SIGN	DESCRIPTION
A	Initial Release	2017/07/27	Lingpeng	New Item.
B	LEN17A0097~112	2017-10-14	Lingpeng	Add The Label And Change The Title
C	NI80019	2019-03-14	Lingpeng	Add All Seals Product

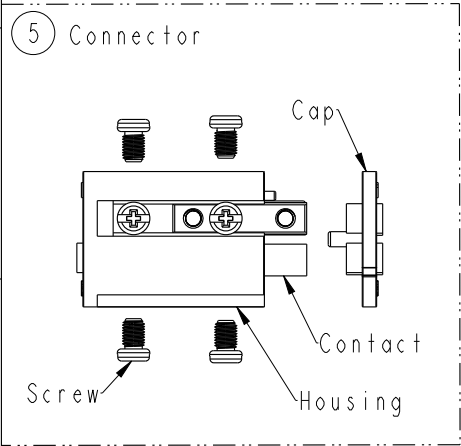

ALTW
CONFIDENTIAL
2019-03-14
R&D DEPT.

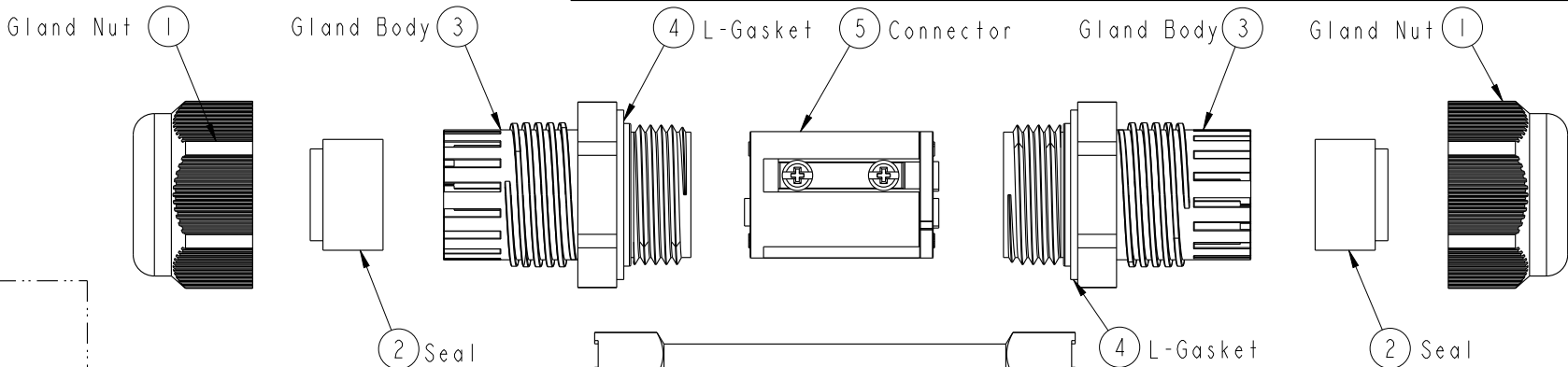
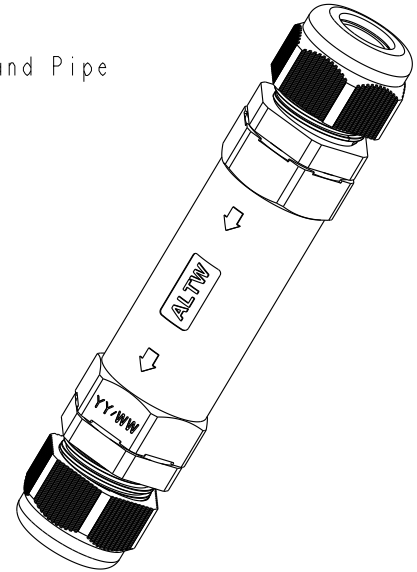
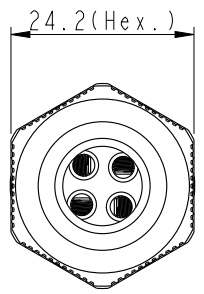
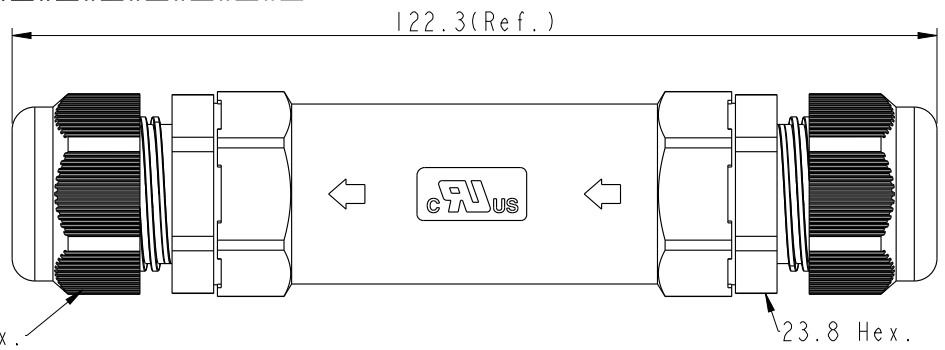
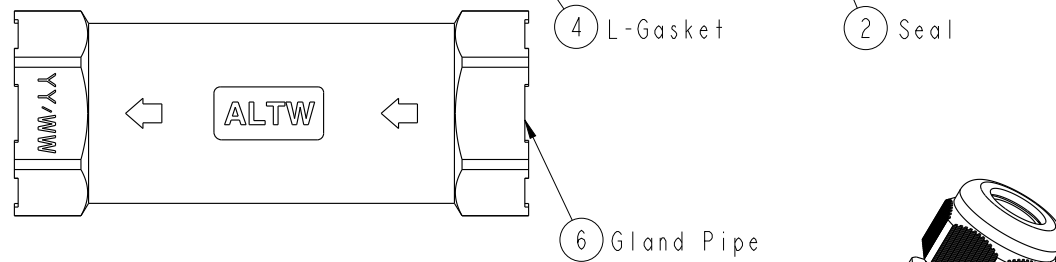

UNIT:mm		
TOLERANCE ±0.5mm		

TITLE UL13 Cable Joiner Screw-in Type		
SCALE 1:1	SIZE A4	SHEET 1 OF 2
REV. C	WC-REV. A.3	Inspection item

Amphenol LTW
安費諾亮泰企業股份有限公司

ITEM NO	DRAWN BY Lingpeng	DATE 2019-03-14
DWG NO SC-L-UL13-XX-XX	CHECKED BY MaFei	DATE 2019-03-14
CUSTOMER ALTW	APPROVED BY Jerry	DATE 2019-03-14

THIS DOCUMENT IS SUBJECT TO CHANGE WITHOUT NOTICE. IT IS CONFIDENTIAL AND A PROPERTY OF Amphenol LTW. DISCLOSURE TO THIRD PARTY HAS TO BE AUTHORIZED BY Amphenol LTW.

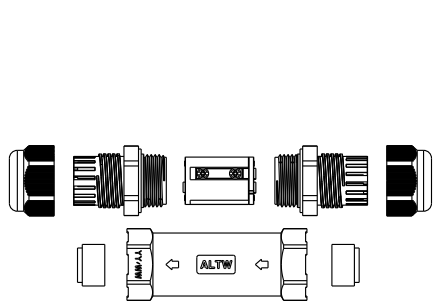

QTY: 1PCS

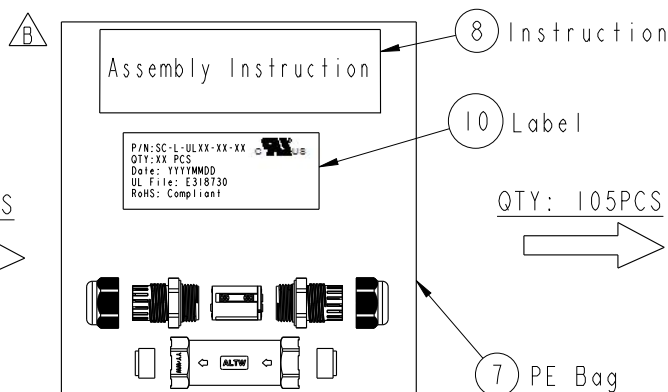
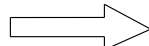

QTY: 105PCS

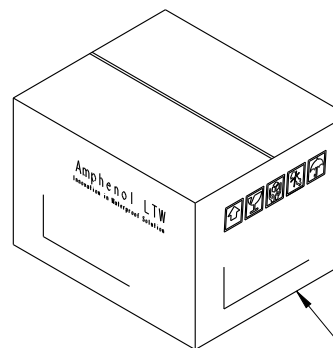
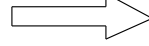

9 Carton

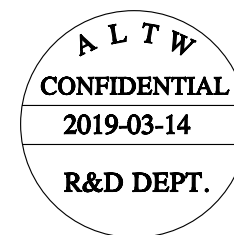

Both A Unassembled product And An Instruction Are In A PE Bag.

(將一套未組裝的產品和說明書，放置於一個PE袋，並封口)

Note:

- * \varnothing Important Dimension To Check.
- * Waterproof Rate: IP68 (50M,24H)
- * Housing & Cap: PA66+GF, Black.
- * Gland Pipe: PA66, Black.
- * Gland Body: PA66, Black.
- * Gland Nut: PA66, Black.
- * Contact: Brass, Nickel Plated
- * L-Gasket : Silicone, Yellow.
- * Seal: Silicone, Blue & Yellow & Green & Red.
- * Rated Voltage: 2~5 Pole 600V AC
- * Rated Current: 2 & 3 Pole Max. 20A ,
4 Pole Max. 15A.
5 Pole Max. 8A.
- * Operating Temperature: -40°~+105°.
- * Gland Pipe Recommended Tightening Torque:
8~10 Kgf.cm(0.78~0.98 N.m)
- * Gland Nut Recommended Tightening Torque:
8~10 Kgf.cm(0.78~0.98 N.m)
- * Seal For Cable OD: \varnothing 4.5~ \varnothing 6.5mm, Blue.
 \varnothing 6.5~ \varnothing 8.5mm, Yellow.
 \varnothing 8.5~ \varnothing 10.5mm, Green .
 \varnothing 10.5~ \varnothing 11.5mm, Red.
- * Screws for Wire connection recommended tightening torque: 2.00~4.50 kgf.cm / 0.196~0.44 N.m
- * Applicable Wire gauge: 18AWG~12AWG(2~4 pole)
18AWG~14AWG(5 pole)
- * UL2238 Certification

SC-L-UL13-XX-XX
L:Cable Joiner
Type: UL13

Seal's Color: BL-Blue(藍色) For Cable Range: \varnothing 4.5~ \varnothing 6.5mm
YW-Yellow(黃色) For Cable Range: \varnothing 6.5~ \varnothing 8.5mm
GN-Green(綠色) For Cable Range: \varnothing 8.5~ \varnothing 10.5mm
RD-Red(紅色) For Cable Range: \varnothing 10.5~ \varnothing 11.5mm
AA-All Seals For Cable Range: \varnothing 4.5~ \varnothing 11.5mm

No. of Conductor: 02-2Poles
03-3Poles
04-4Poles
05-5Poles

Pole Assignments Front View	2 Pole	3 Pole	4 Pole	5 Pole

UNIT:mm		TITLE	UL13 Cable Joiner Screw-in Type	
TOLERANCE	±0.5mm	SCALE	1:1	SIZE A4
		REV.	C	WC-REV. A.3
			SHEET 2 OF 2	
			☉: Inspection item	

Amphenol LTW
安費諾亮泰企業股份有限公司

ITEM NO	DRAWN BY	DATE
	Lingpeng	2019-03-14
DWG NO	CHECKED BY	DATE
SC-L-UL13-XX-XX	MaFei	2019-03-14
CUSTOMER	APPROVED BY	DATE
ALTW	Jerry	2019-03-14